

AXS-320T-LD Vault

Equivalent to an FTTH Flowerpot 10" Round Vault

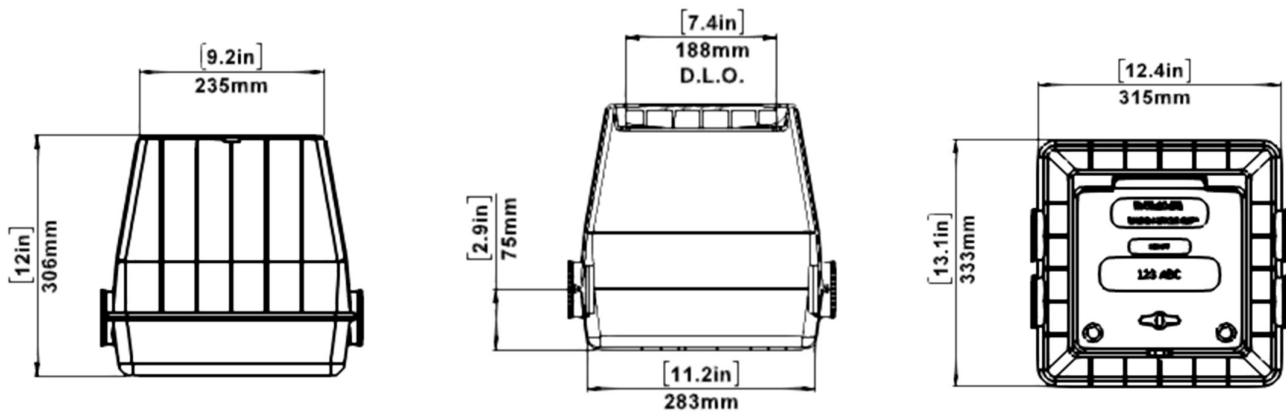

Specs & Techs: AXS-320T - LD Access Point / Flowerpot



Description:

The AXS-320T-LD is a purpose designed mini access box, or boundary box, that will cater for low fiber count connections. The AXS-320T-LD is normally used to connect MDU's or single use Clients from the network.

Features & Benefits:

- Ideal for low density traffic installations. Depending on splitter configuration, up to 12 clients can be connected.
- The unit can be split between base or pan and chamber section to allow installation over existing networks.
- Low surface footprint unit 8.4" x 8.4" [213mm x 214mm]
- No tools required for assembly - press-on clips complete the assembly.
- Duct ports are sealed with rubber grommets allowing interface with multiDuct and/or microDuct. No foaming agent or additional sealants are required.
- Knock-down design allows high packing density for transport savings.



CONTACT & INFORMATION:

Tel: (920) 328-1020 Email: sales@raddnetwork.com Website: RaDDNetwork.com



Technical Specifications:

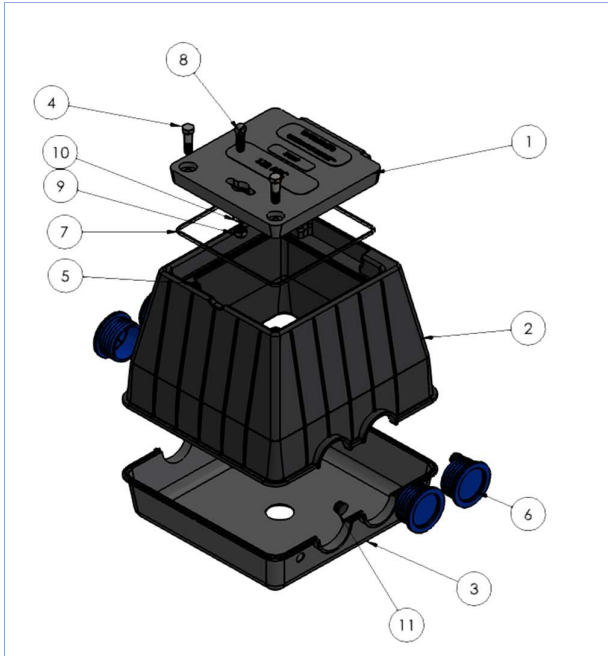

ITEM	PRODUCT CODE	AXS-320T-LD
1.	320TNF-LIDBOLTD	PP, UV stabilised (Black) Lid
2.	320TNF-TOPBOLTD	PP, UV stabilised (Black) Top
3.	320TNF-BASE	PP, UV stabilised (Black) Base
4.	FS031	7/16" Bolt (Locking)
5.	FS51	7/16" Nut
6.	REDPLUG50	2.4" Reducer Coupling (Optional)
7.	320TNF-ORING	320T O-Ring
8.	FS034	Lifting Eye (M10)
9.	FS016	M10 Lock Nut
10.	FS036	M10 Washer
11.	320T-GROMMET	Rubber Grommet



ITEM	PRODUCT CODE	AXS-320T-LD
1.	320TNF-LIDBOLTD	PP, UV stabilised (Black) Lid
2.	M4A-NL	Nylon Lock
3.	320RSEAL	6mm NBR O-Ring
4.	320TNFCOMPBO LT	PP, UV stabilised (Black) Top
5.	320TNF-BASE	PP, UV stabilised (Black) Base
6.	320TCLIPS	Nylon Clips
7.	320TCAPS	PVC End Cap

Weight & Load Class:

	AXS-320T-LD
Weight lbs/KG	5.5lbs [2.5kg]
Load Class:	
ANSI	Light Duty Application

Shipping:

LOADING QTY'S (PRODUCT CODE)	40' CONTAINER [12M]
AXS-320T-LD	3,240

Installation Instructions:

As with all structures, proper installation and backfilling are critical. Improper installation practices may lead to failure. All practices should comply with OSHA, State, Federal regulations.

STEP 1 - BEDDING

Vault should be placed on a minimum of 6" of properly compacted, free draining material. ¾" washed stone or sand is recommended.

STEP 2 - BACKFILLING

Backfilling around vault should be done uniformly around vault in 3"-4" lifts. Material should be properly compacted to meet project specifications; excessive mechanical compaction should be avoided.